

M912



# DIY mini house kits - Moonlight over the Lotus Pond

# NOTICE OF ASSEMBLE

## Tips for assembling

1. Pictures shown on the package may be slightly different from the actual product.
2. All the materials are taken in the operation step, put the remaining materials back into the original pocket until the installation is completed. (Avoid material loss during installation)
3. The dimensions indicated in the step diagram are "cm".
4. If there have template paper material, please cut the material according to the template to avoid mistakes..
5. According to the part rule example at the bottom of this page, refer to the part on the part number drawing, find the material object and compare with the material list, confirm and install. (Wooden parts only)
6. Glue should not be applied too much, so as not to dry longer, overflow will affect the effect of the finished product.
7. Part shapes may differ from the photographs depending on the production batch

## Testing on LED function

Be sure to test the LED lights before making the lighting, note that the LED white wire to the negative, gray wire to the positive reference to the following figure operation test.

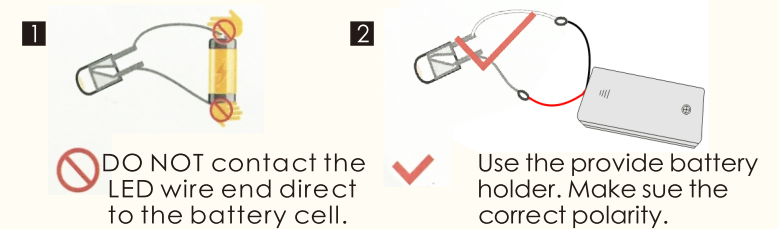

## Product comes with tool:

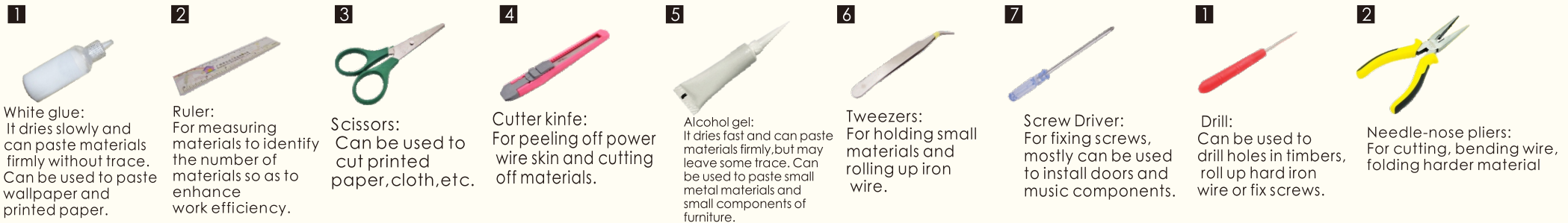

## Bring your own tools:

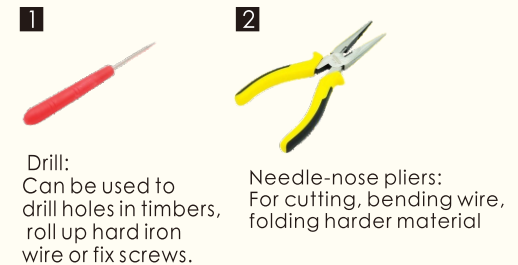

## How to assemble the battery holder

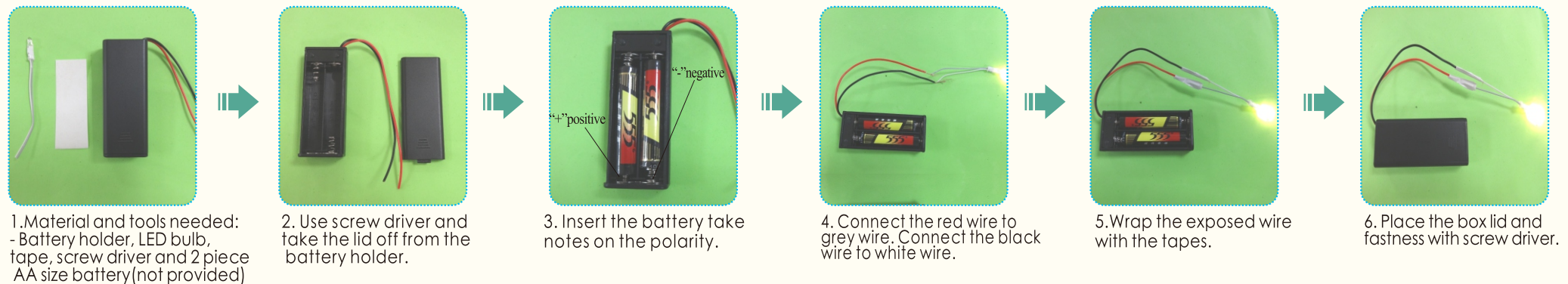

## Example of parts rule:

A01: The parts are directly in the box.; B01: parts in bag B; C01: part in bag C, and so on.

(Note: display the printing paper A15-01 in the step: the printing paper is placed directly in the box, part number is A15-01)

## details of miniature kit

Name	Material package
printing paper	Bag A-A15(All printing and template papers are shown on A15 paper, total 3pieces of A3 )
mirror	D bag +G bag+ printing paper
bridge	D bag+printing paper
zhongruan	D bag+ printing paper
chinese zither	D bag +G bag+printing paper
cabinet	D bag +printing paper
outdoor table and chair	D bag+G bag+H bag+printing paper
plant rack	D bag+G bag+H bag+printing paper
table	E bag+G bag+H bag
single chair	E bag+G bag
multi-person chair	E bag+G bag
bed	E bag+G bag
tea table	E bag+G bag+H bag
desk and chair	F bag+G bag+H bag+printing paper
swing chair	F bag+G bag+H bag
parlor and pavilion lamp	H bag+printing paper
bedroom light	F bag+G bag+H bag
grape trellis lamp	F bag+G bag+H bag
lotus leaf	printing paper
big flower potted	H bag+printing paper
climbing vine	G bag+H bag
outdoor plant	G bag+H bag
indoor flower	G bag+H bag
lotus	G bag
stairs	B bag+printing paper
pavilion	A bag+B bag+C bag+H bag+printing paper
outer frame	A bag+B bag+C bag+printing paper
outer frame	A bag+B bag+C bag+H bag+printing paper
battery holder	H bag

## Thumbnail of material list( reference only)

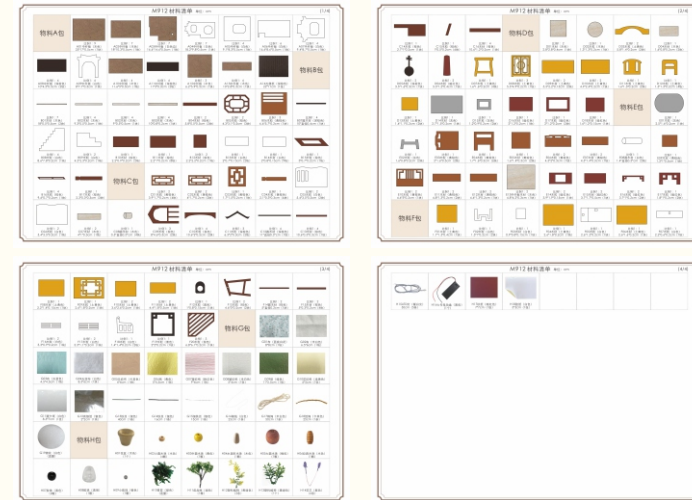

## Thumbnail of printing paper & template paper( reference only)

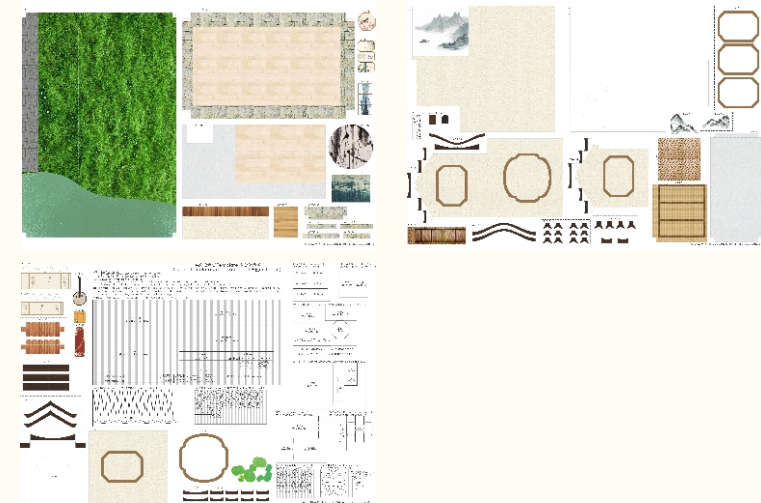

## Symbol description used

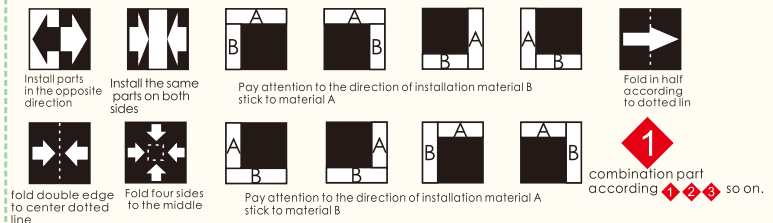

**Mirror**

Cut out the material G12 according to the template paper before making.

A15-05  
D01  
G18  
G12 (mirror)  
D02  
G12 (mirror)  
D02  
1.7cm  
1.7cm  
G18 single rope: 3.4cm  
A15-05  
D01

**Bridge**

A15-19  
D03  
D04  
D03  
D04  
D03  
D04  
D03

**Zhongruan**

**Chinese zither**

D05  
A05-37  
A05-37  
D05  
D07  
D07  
D07  
D07  
D06  
A15-39  
G16

**Chinese zither**

G16: 3.3cm (4 pieces), 3.4cm (2 pieces), 3.5cm (1 piece)

A15-39  
D06  
G16: 3.3cm  
D07  
D07  
0.3cm  
0.3cm  
(2 pieces)

**Cabinet**

D09  
D09  
D10  
D08  
A15-28  
D08  
D09  
D09

**Outdoor table and chair**

Cut out the material G11 according to the template paper before making.

D14  
A15-38  
H02 (chessboard)  
G11 (chessboard)  
D13  
D11  
D12  
D12  
D11  
D13  
D15  
D12  
D12  
D11  
D13  
D15  
D12  
D14  
(2 pieces)

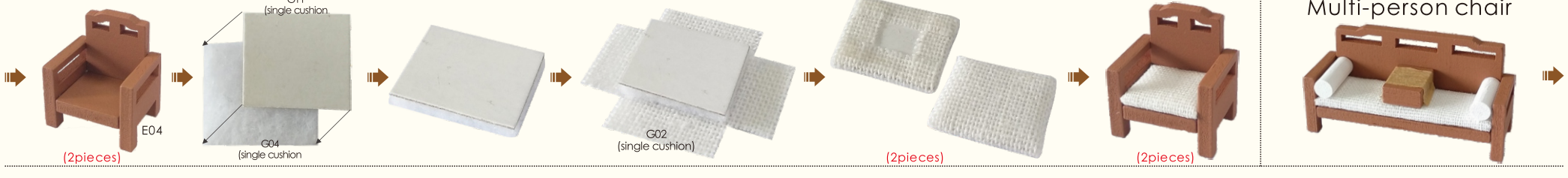
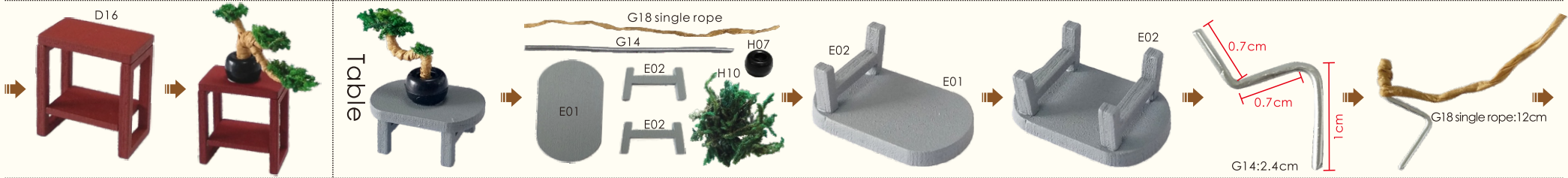
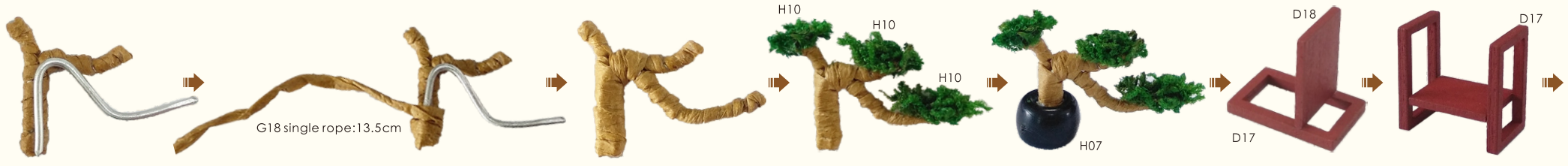
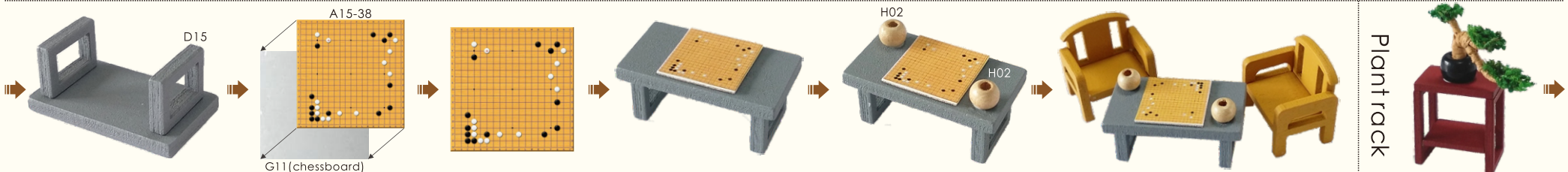

Cut out the material G02, G04 and G11 according to the template paper before making.

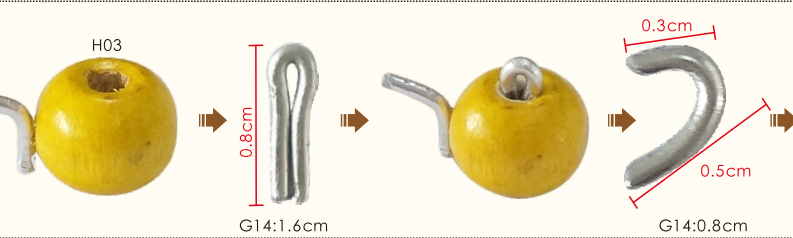
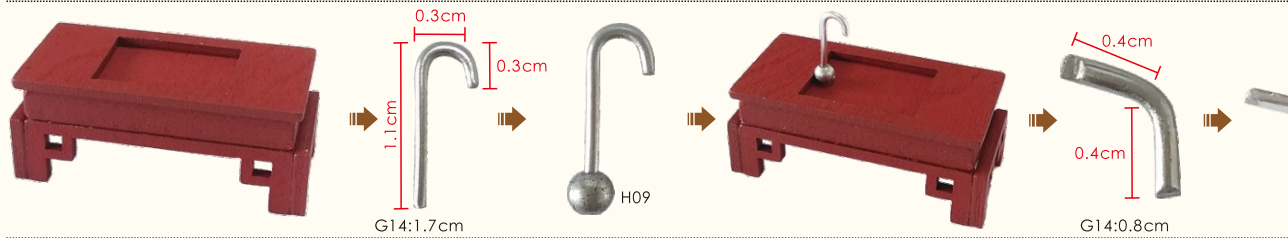
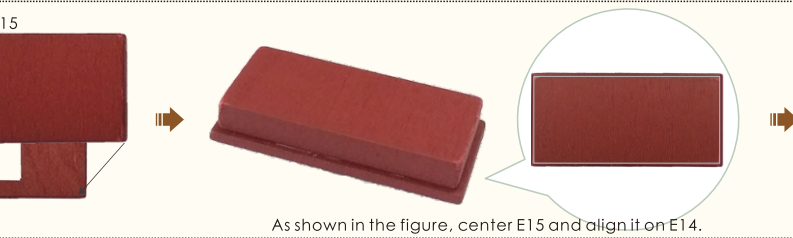
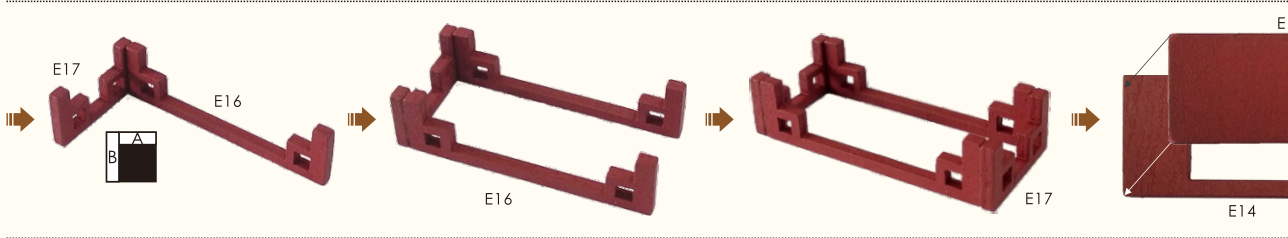
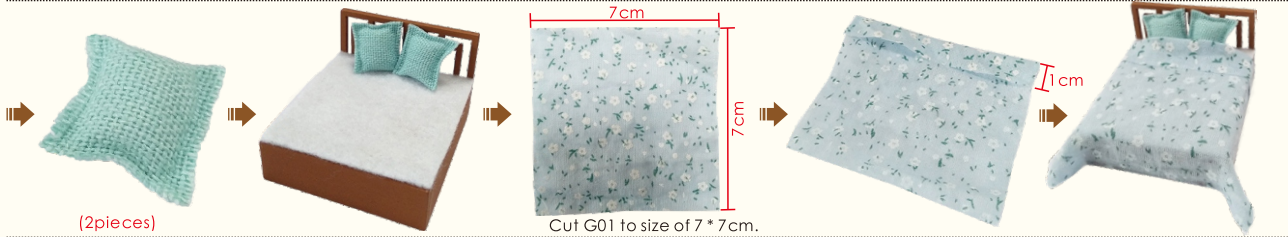
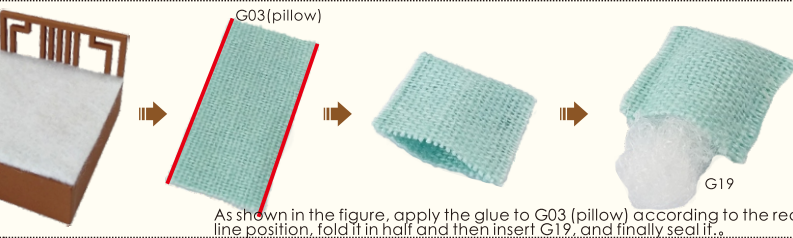
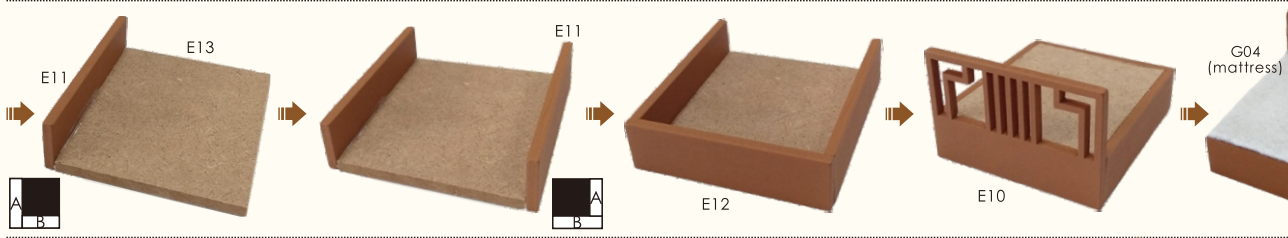

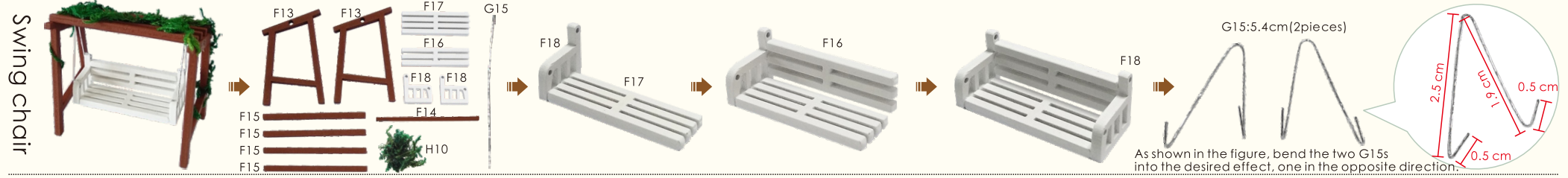
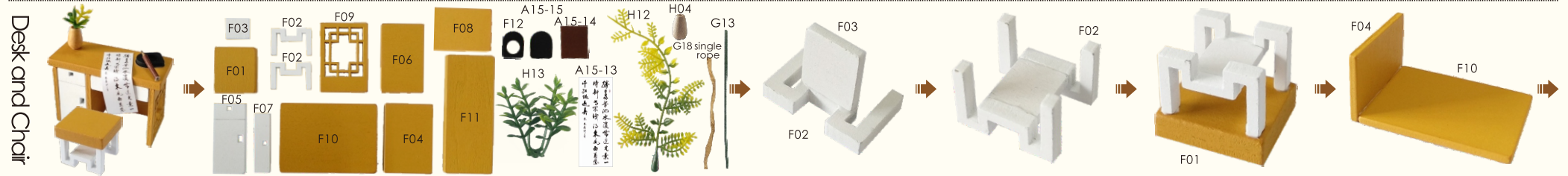

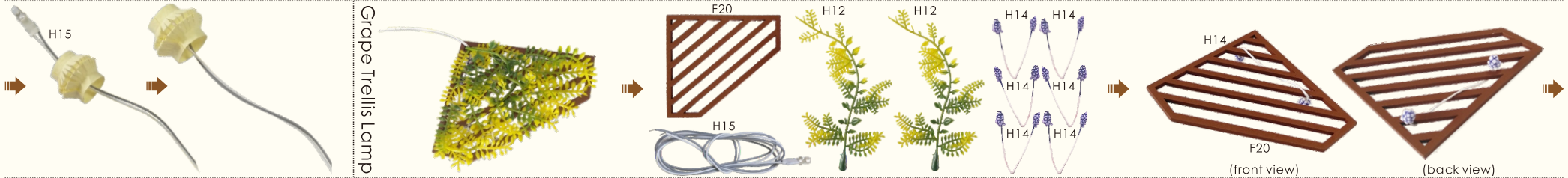
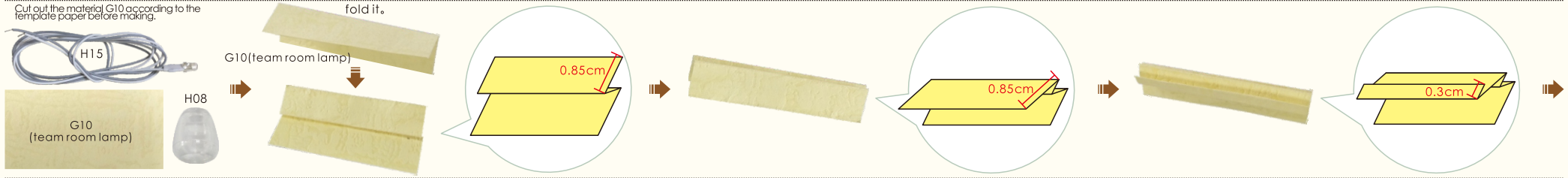
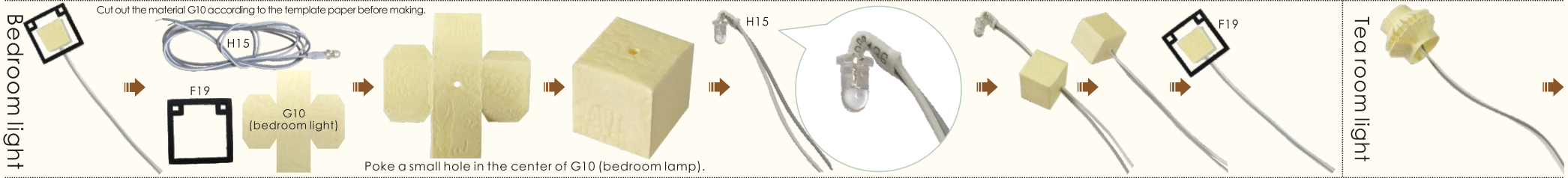
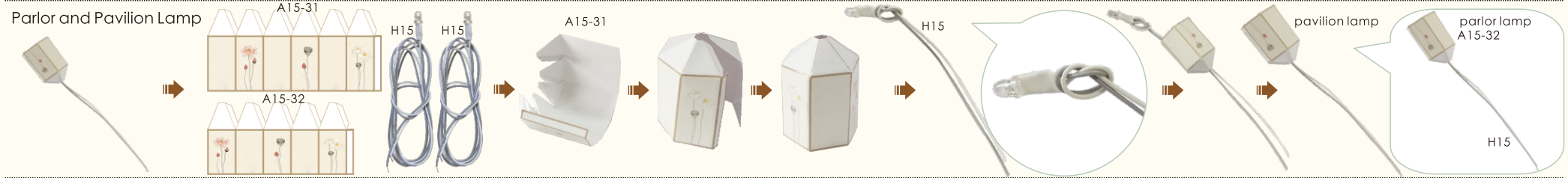
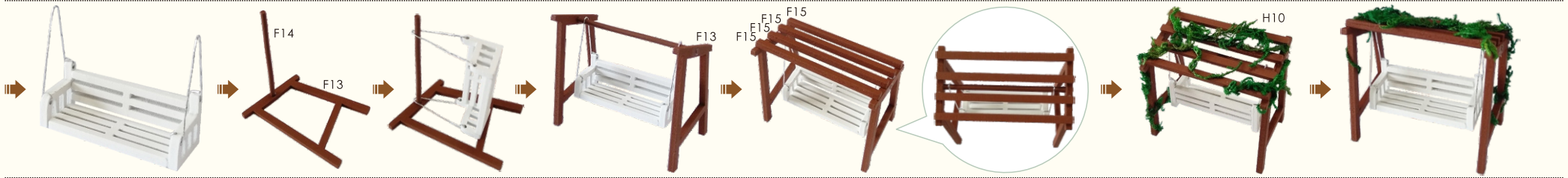

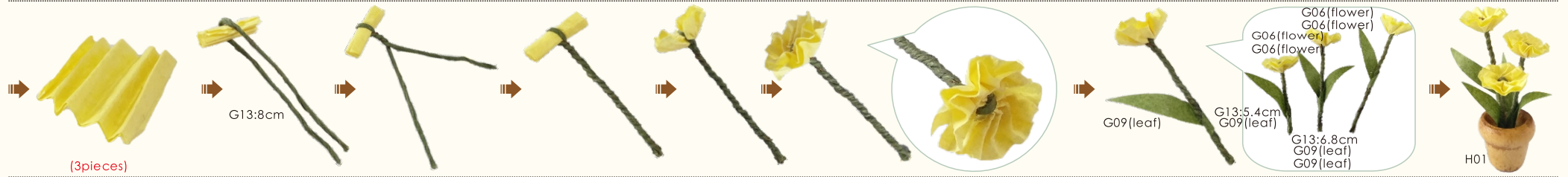
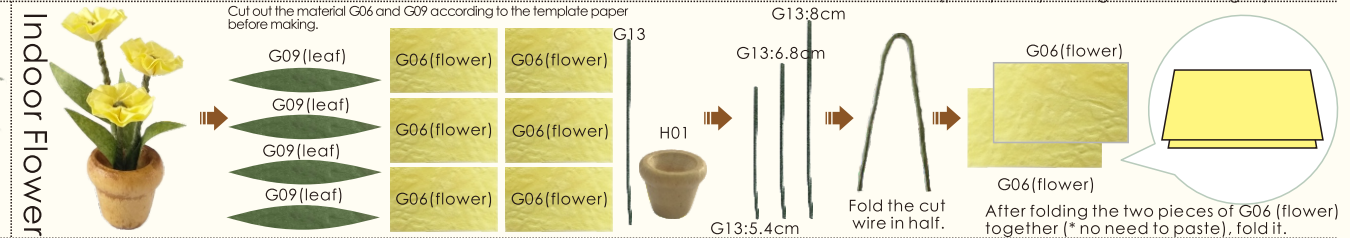
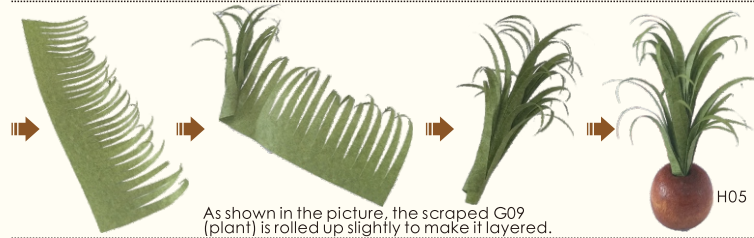
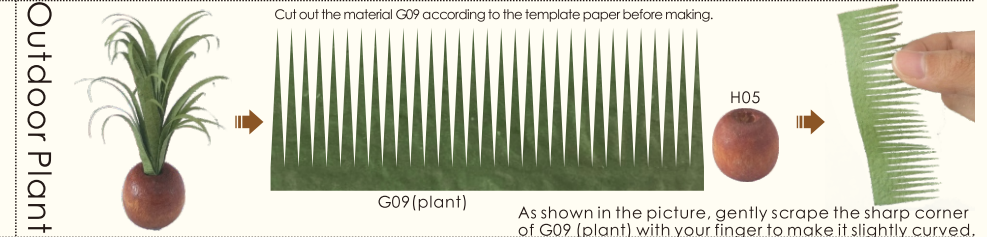
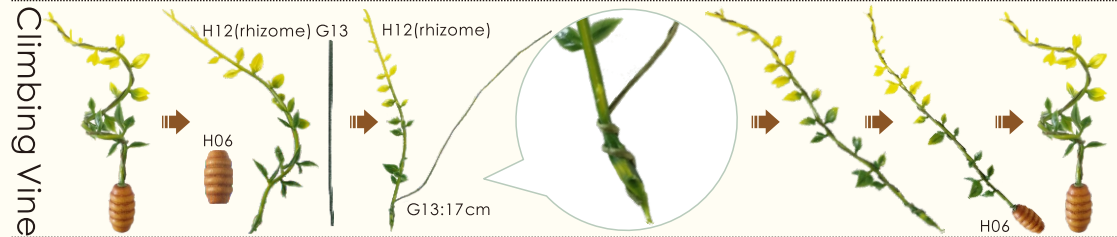
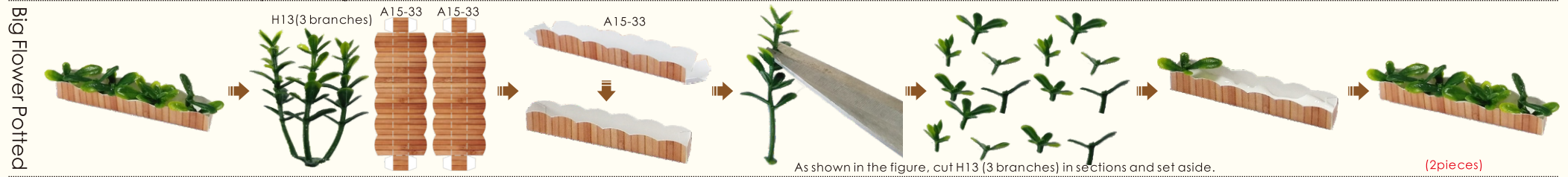
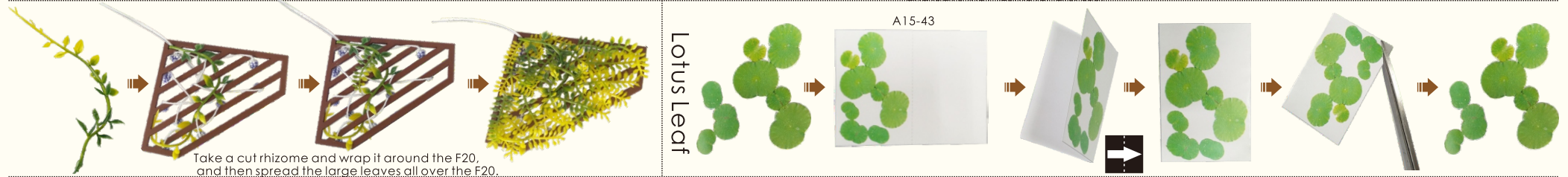
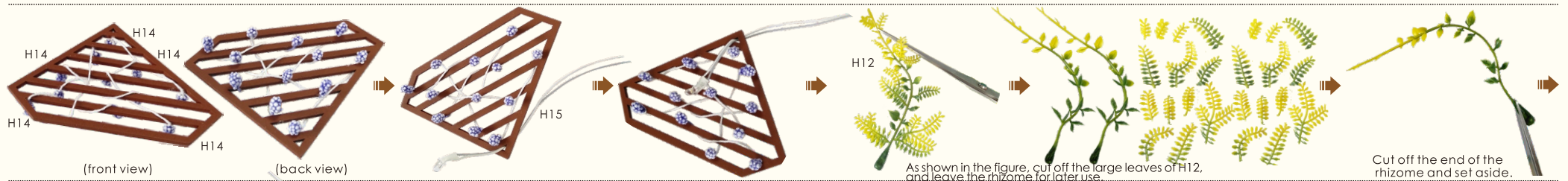



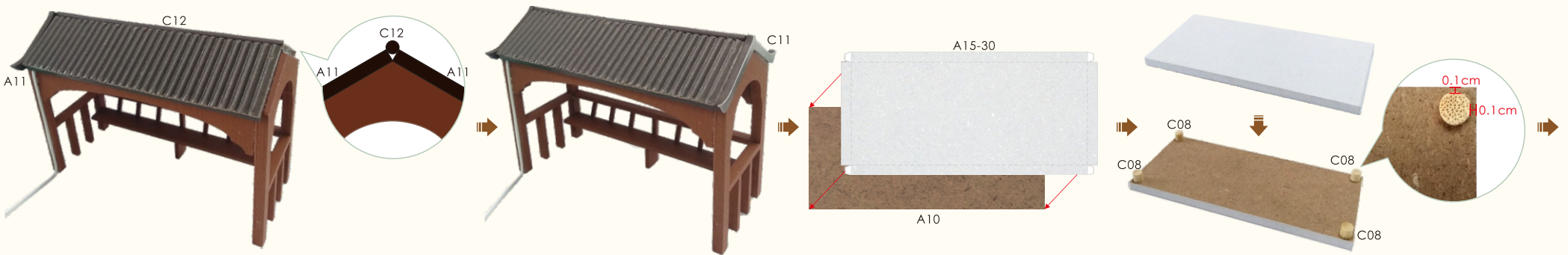
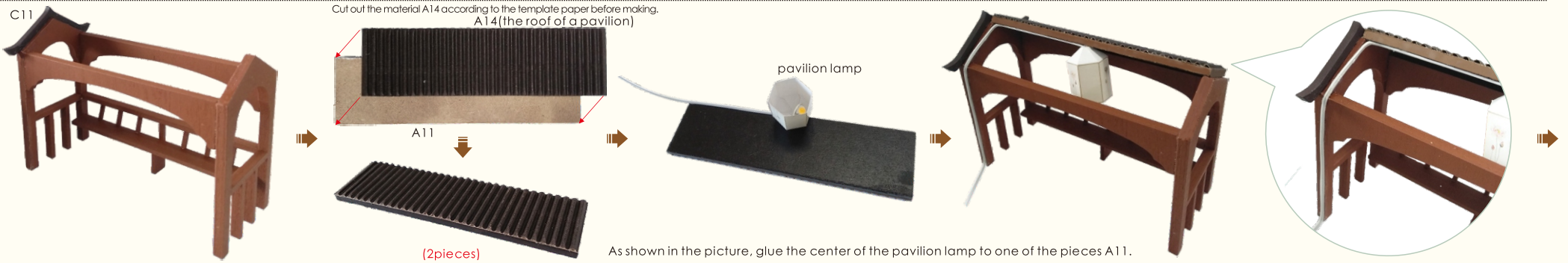
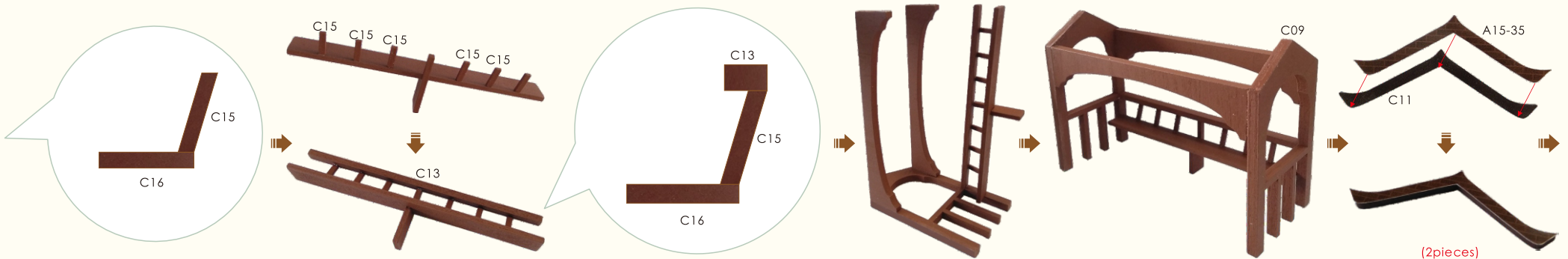
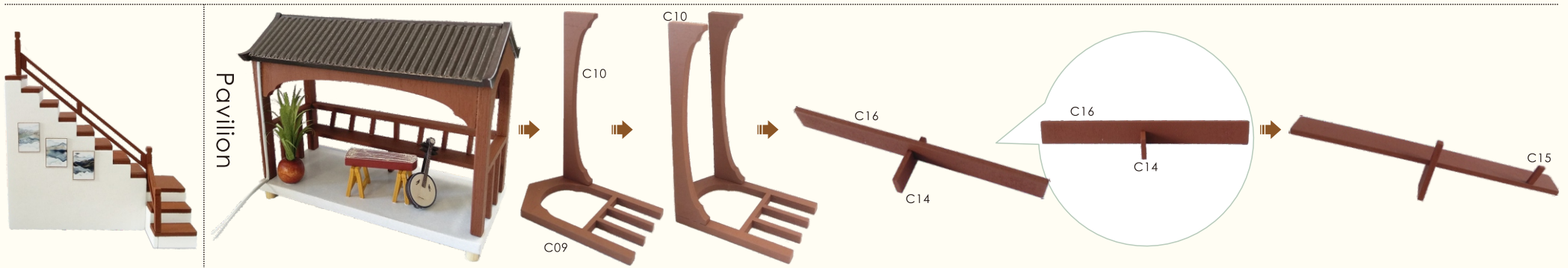

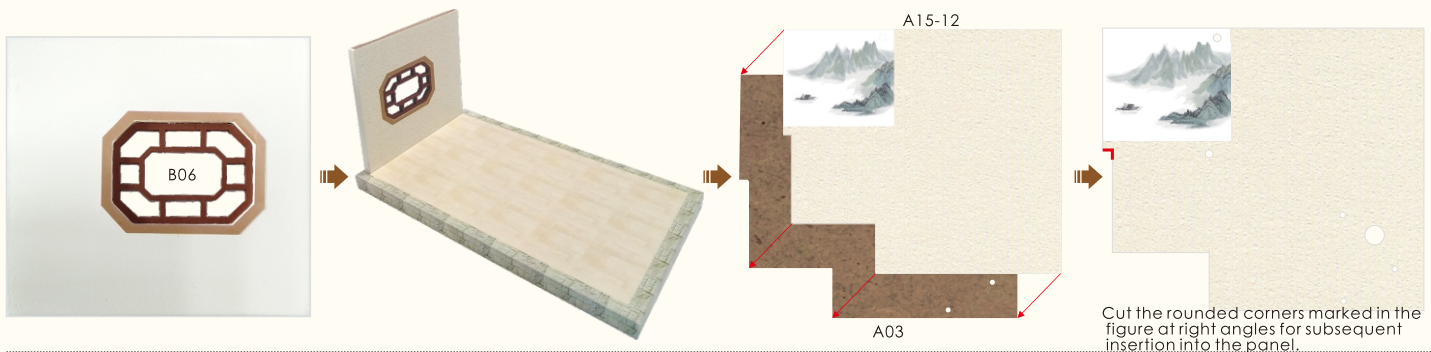
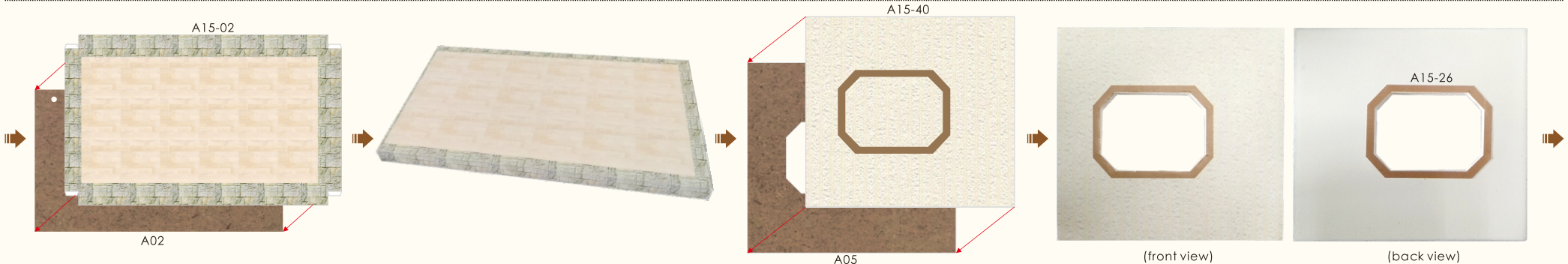
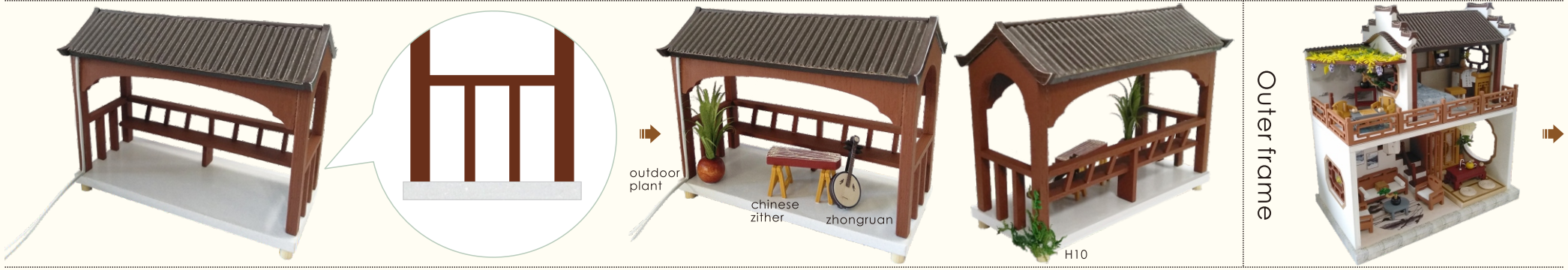

**Music machine core manual guide**  
(If you have purchased the music machine core, please fix it firstly)

 J01 Music machine core 1piece	 J02 Screw 3pieces	 J03 Music machine core handle 1piece
(front view)  J01	(back view)  J02 J02 (*Don't install J03 first!)	

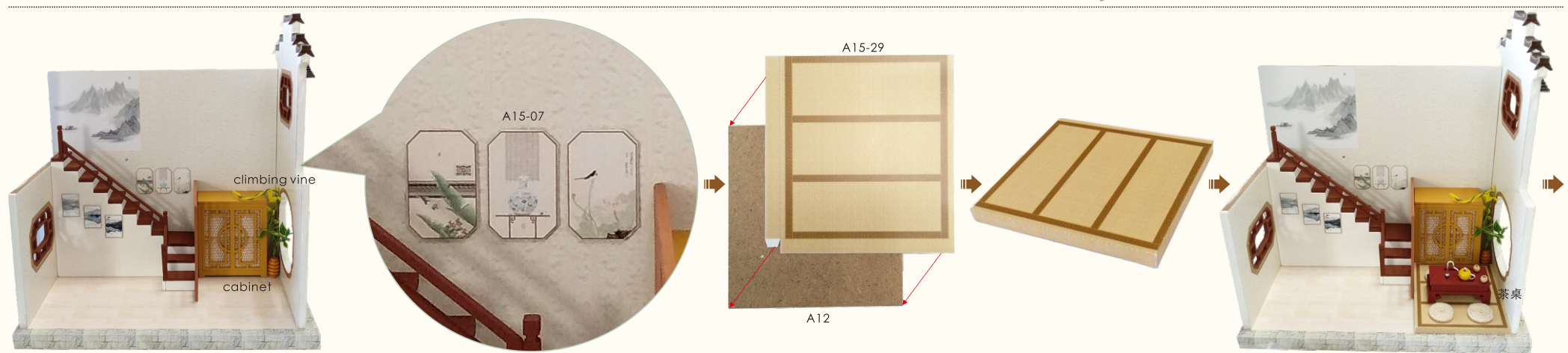
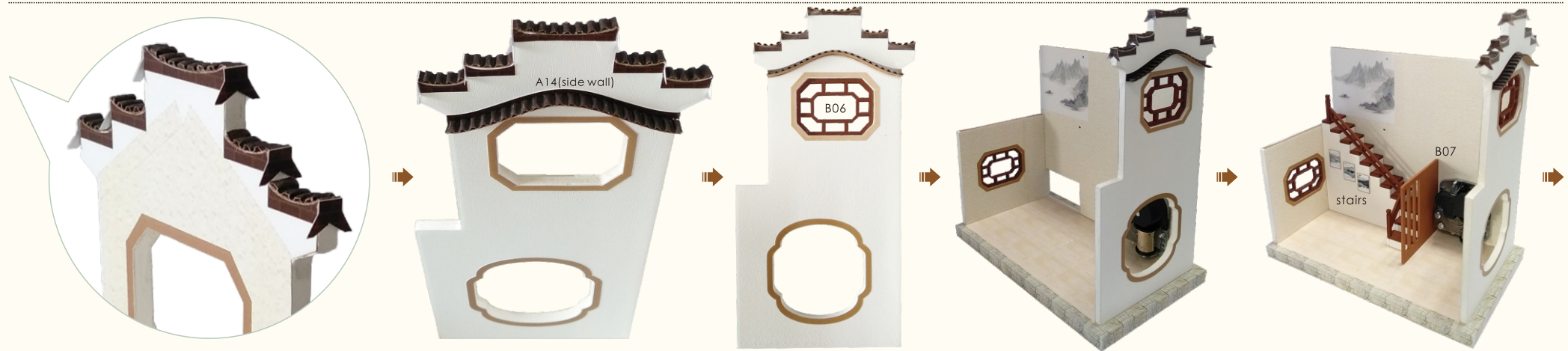
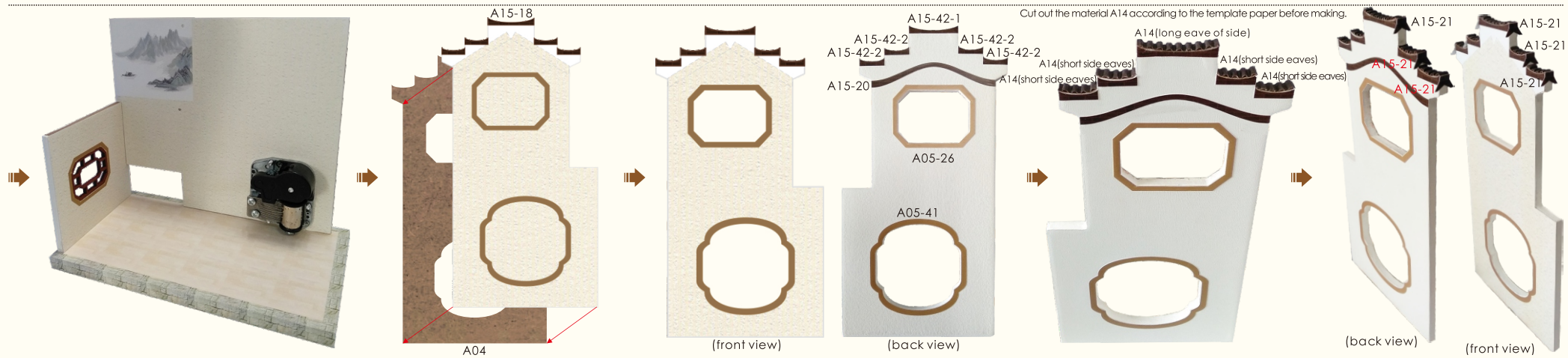

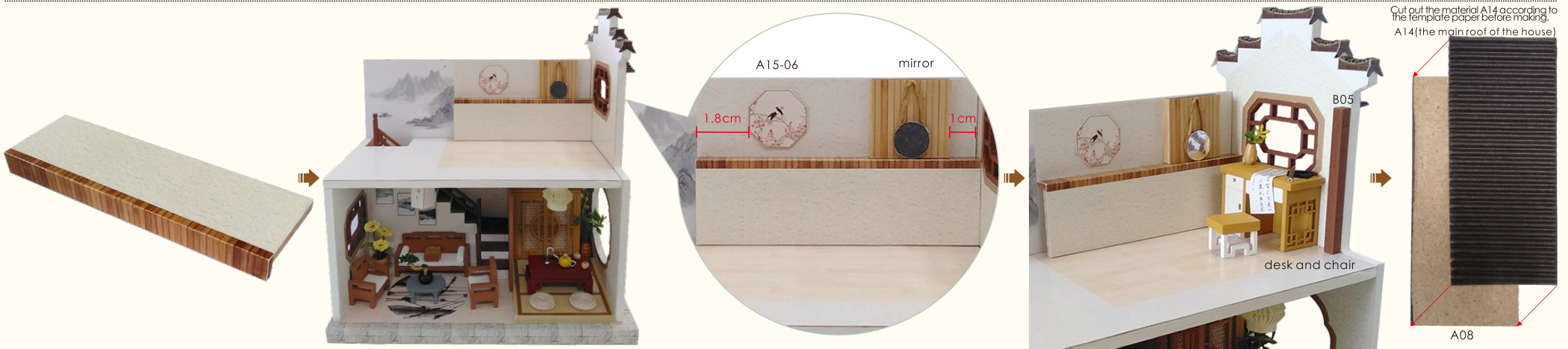
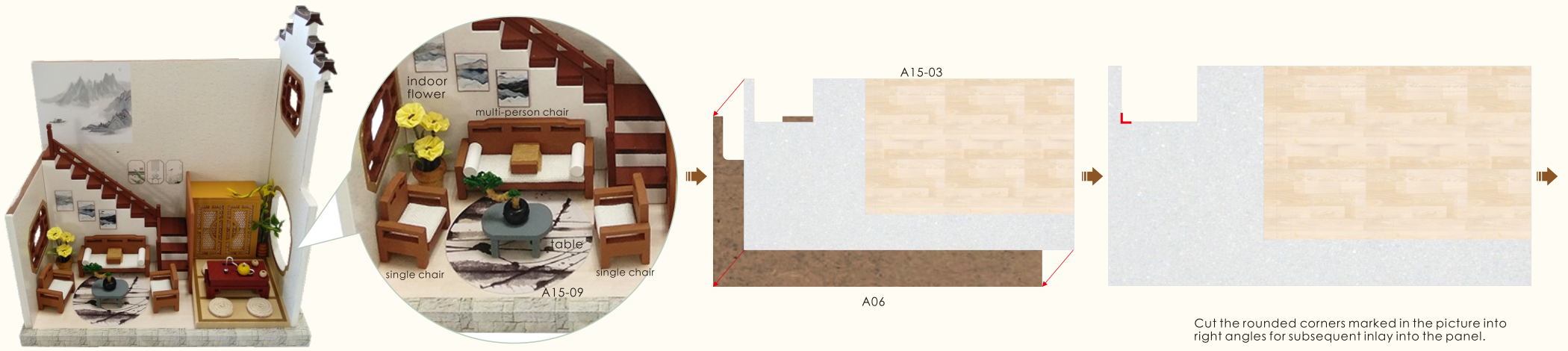

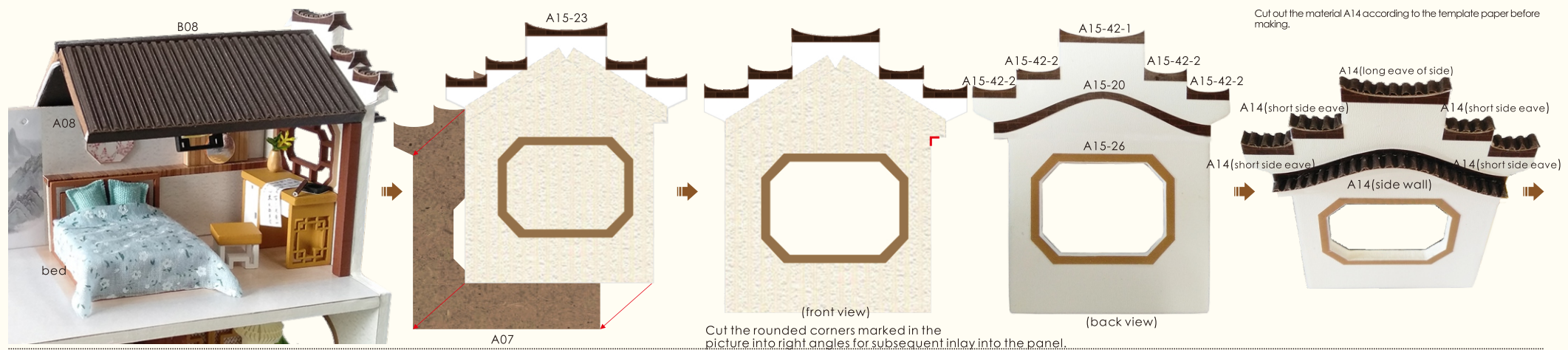
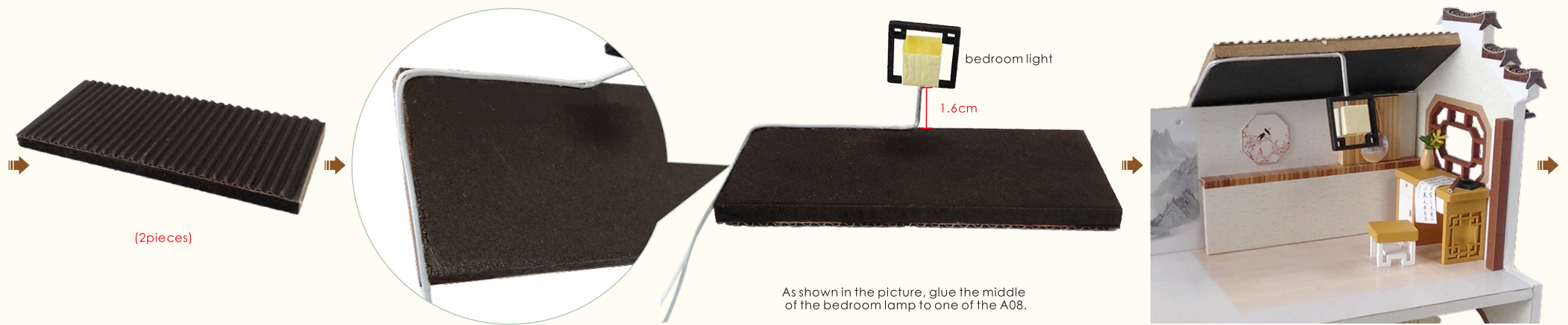



\*If you have purchased the movement, please install J03 in this step.

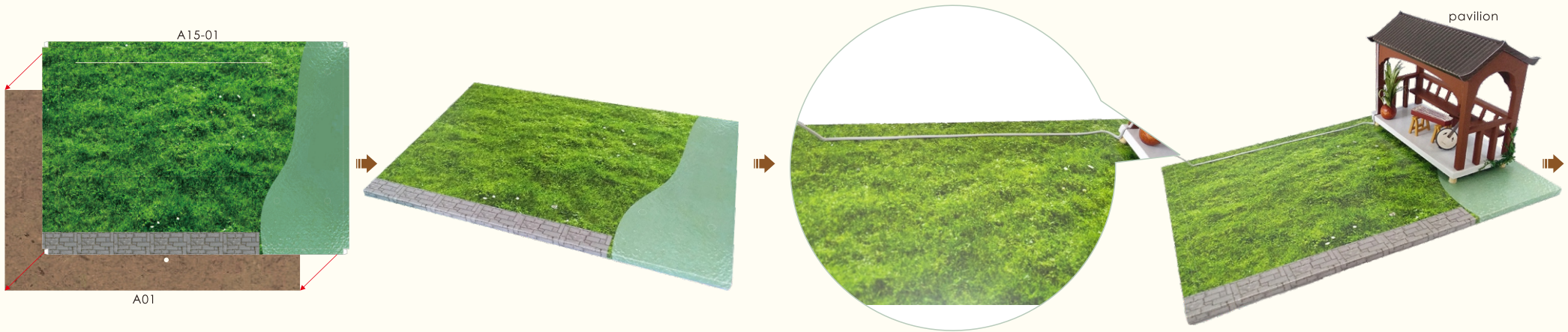

Cut out the material A14 according to the template paper before making.



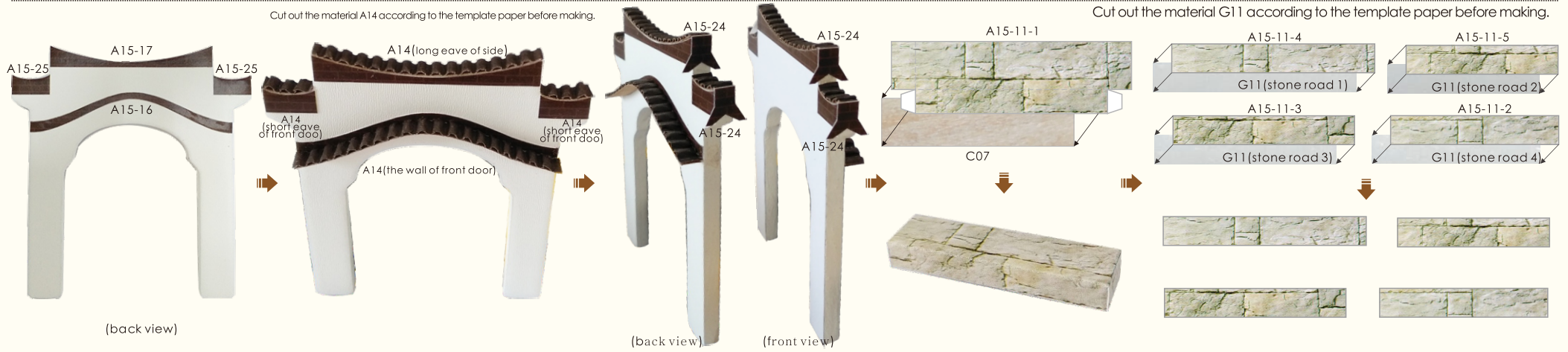

### How to assemble the battery holder

Statement: the lamp wires cannot be inserted into the output socket.

- - Can use 7 batteries
- - Please notice the place of anode and cathode when put in the batteries
- - Rechargeable batteries are not blunt electricity
- - Rechargeable batteries can only be charged under adult supervision
- - Rechargeable batteries should be removed from the toy before charging
- - Different types of batteries cannot mix; Do not mix new batteries in use with semi-used batteries.
- - Run out of battery should be removed from the toy
- - The power shall not be short circuit

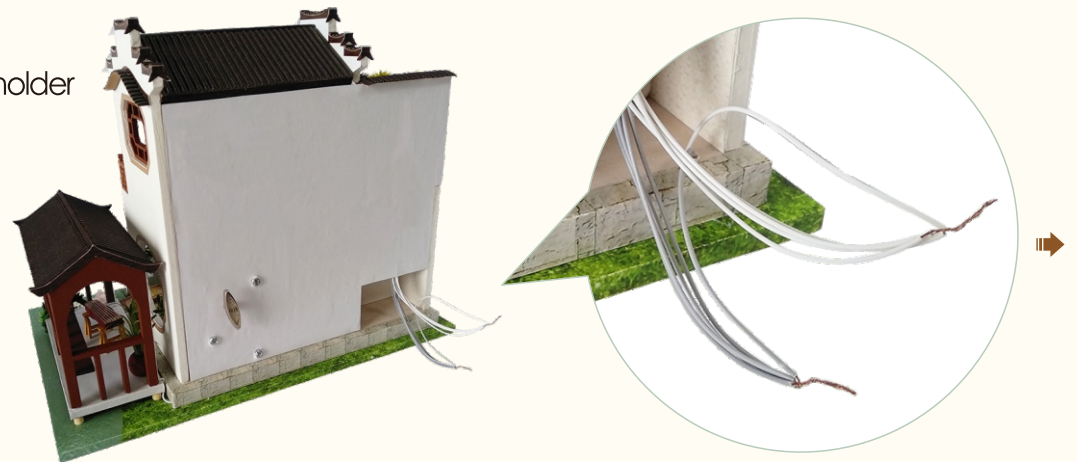

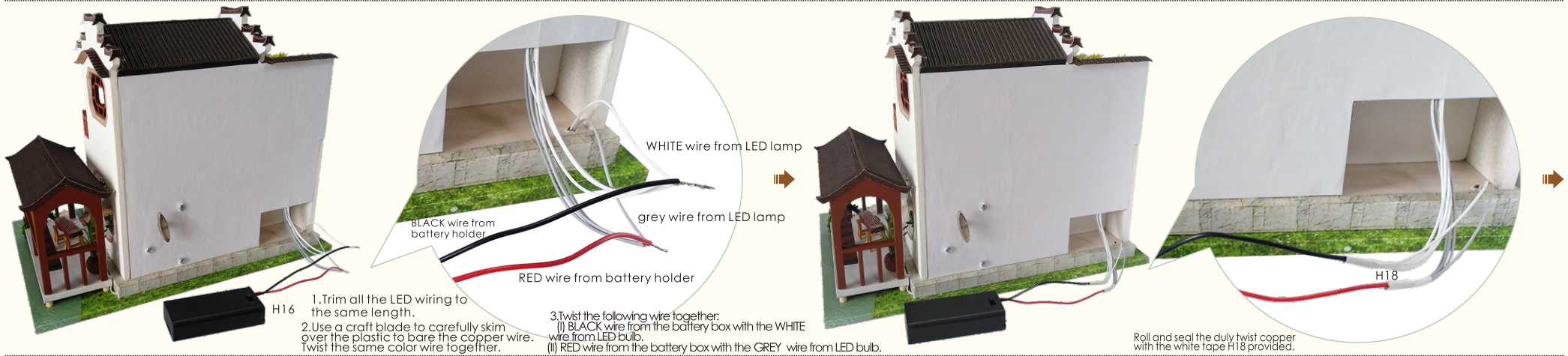

As shown in the picture, the battery box is put into the empty slot.

Installation of dust proof cover  
(For updated version, the parts need to be purchased separately)



scale 1:6  
J04 Transparent cover  
25\*21\*0.15cm  
2pieces



scale 1:6  
J05 Transparent cover  
21\*16.7\*0.15cm  
2pieces



scale 1:6  
J06 Transparent cover  
25\*17\*0.15cm  
1piece

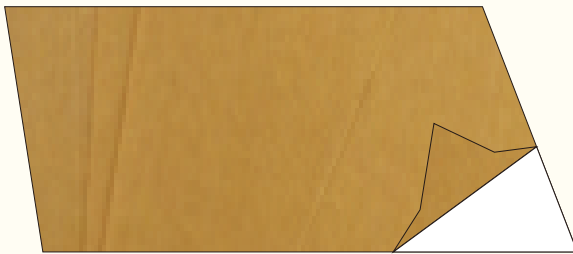

1. Tear off kraft paper of each piece of transparent cover.

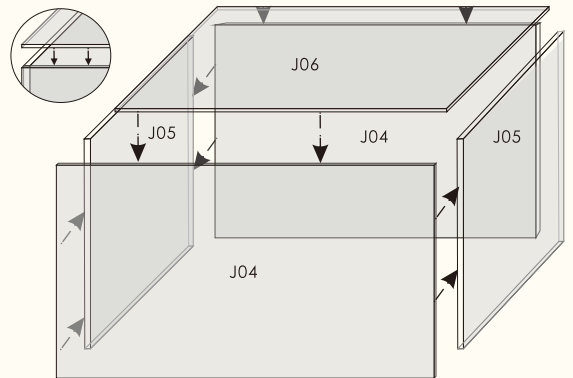

2. Paste J04, J05 and J06 together to complete the dust proof cover as shown.

Photo of Dust proof cover



Photo gallery



Attention: Please keep the instruction for future enquires after installation.